

# RACK MOUNT ENCLOSURE with HANDLE - YERH series

## Assembly Drawing

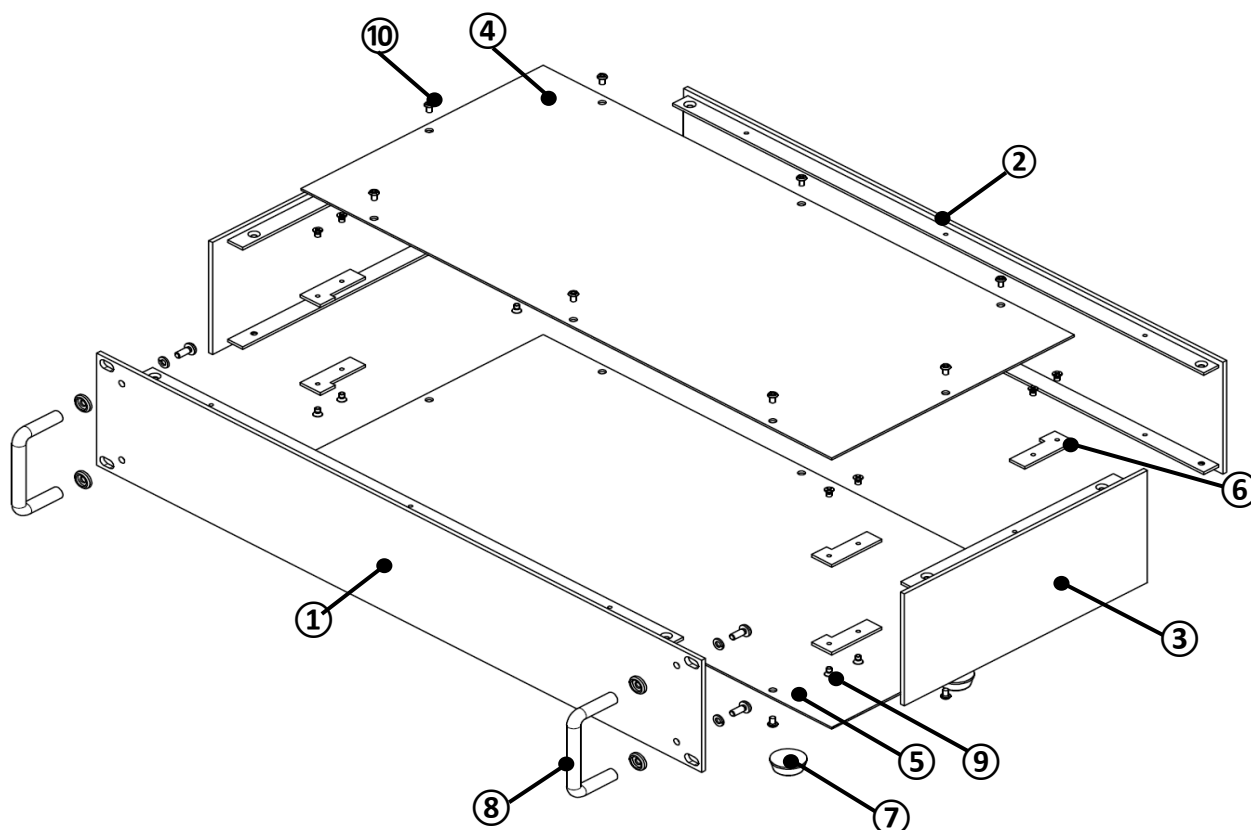

### Components

① Front panel	1 pc
② Rear panel	1 pc
③ Side plate	2 pcs
④ Top cover	1 pc
⑤ Bottom cover	1 pc
⑥ Support bracket	8 pcs
⑦ Rubber feet	4 pcs
⑧ Handle (with washer)	2 pcs
⑨ M3-5 countersunk	16 pcs
⑩ M3-5 original trapezoid head (plus)	16 pcs

### Assembly Instructions

1. Attach the ⑧ handle on the ① front panel.
2. Install the ⑥ support brackets on the ③ side plates.
3. Attach the ① panel with ⑧ handle and ② rear panel on the ⑥ support brackets installed on the ③ side plates in Step 2.
4. Install the ④ top cover and ⑤ bottom cover.
5. Install the ⑦ rubber feet.

\*Top & botom covers are protected with a protective film on one side. Remove before assembly.



[www.takachi-el.co.jp](http://www.takachi-el.co.jp)

**TAKACHI ELECTRONICS ENCLOSURE CO., LTD.**  
 TEL : 048-222-5430 E-mail : [info@takachi-el.co.jp](mailto:info@takachi-el.co.jp)